

# Prep Pro 6000-D Prep Station - NESHAP Rated 2 Stage Filtration System

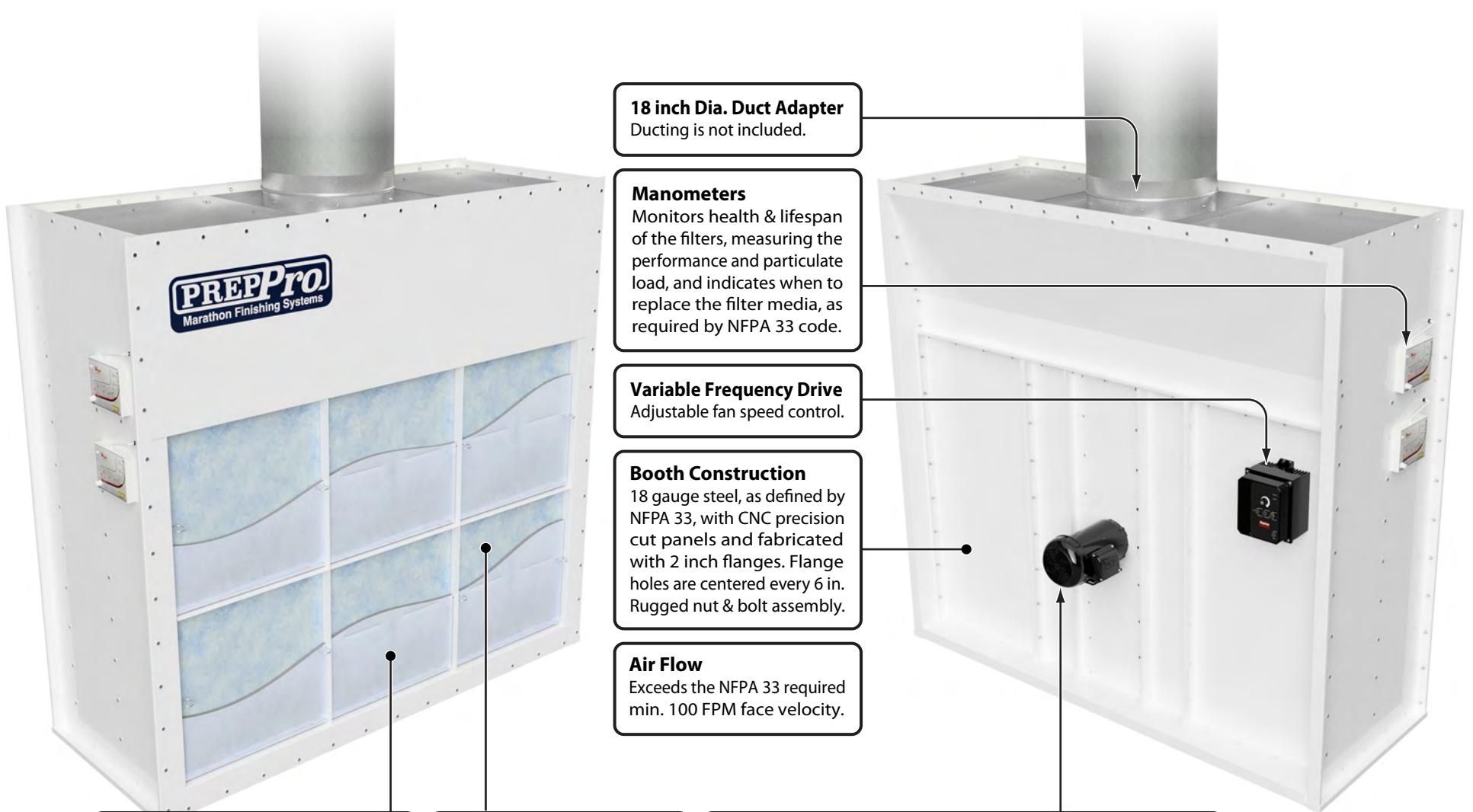

**18 inch Dia. Duct Adapter**  
Ducting is not included.

**Manometers**  
Monitors health & lifespan of the filters, measuring the performance and particulate load, and indicates when to replace the filter media, as required by NFPA 33 code.

**Variable Frequency Drive**  
Adjustable fan speed control.

**Booth Construction**  
18 gauge steel, as defined by NFPA 33, with CNC precision cut panels and fabricated with 2 inch flanges. Flange holes are centered every 6 in. Rugged nut & bolt assembly.

**Air Flow**  
Exceeds the NFPA 33 required min. 100 FPM face velocity.

**1st Stage Exhaust Filters**  
Fiber pre-filters, intended to catch the bulk of larger aerosolized particulates.

**2nd Stage Exhaust Filters**  
NESHAP rated filters that remove finer aerosolized particulates.

**1 1/2 HP TEFC Motor**  
UL or other NRTL listed motor. Sealed, and outside the NFPA 33 required 3 ft. distance from openings. Aluminum spark-proof fan.



Electrical Requirements	
120 Volt, 60 hz, Single Phase AC, 14 Amps	

Outlet/Plug Type
NEMA 5-20P

Components
(1) 1 1/2 HP TEFC Motor
(2) Manometers
(6) 1st Stage Pre-Filters (Fiber)
(6) 2nd Stage NESHAP Filters

Specifications
• All panels are CNC cut 18 gauge steel per NFPA 33
• Precision cut holes every 6 inches on center
• Full 2 inch companion flanges
• 2 stage filtration using 24" x 24" filter media



Marathon Finishing Systems, Inc. <a href="http://www.MarathonFinishing.com">www.MarathonFinishing.com</a> Ph: 310 791-5601
<b>Product:</b> Ducted Prep Station <b>Model:</b> Prep Pro 6000-D